



Power Assist Wheelbarrow Owner's Manual



PAW Model: 44009

PLEASE DON'T RETURN THIS PRODUCT TO THE STORE!

- HAVING PROBLEMS? - INSTALLATION QUESTIONS? - NEED PARTS? - TROUBLESHOOTING?

CONTACT CUSTOMER SUPPORT FIRST!

1-800-495-9278

WWW.MY-PAW.COM

Monday-Friday 8am-5pm Central Time

Decko Products - 2301 Traffic St. NE - Minneapolis, MN 55413

Table of Contents

• Table of contents _____	Page: 2
• Congratulations on your purchase _____	Page: 3
• Safety guidelines and safety information _____	Page: 4
• Battery and tire care _____	Page: 5
• Parts inventory _____	Page: 6
• Assembling the main frame _____	Pages: 7-8
• Assembling drive system _____	Pages: 8-9
• Attaching the left handle _____	Page: 9
• Attaching electronics box and right handle _____	Page: 10
• Attaching the motor protective cover _____	Page: 11
• Attaching the battery box _____	Page: 12
• Attaching and adjusting wiring _____	Page: 13
• Attaching the tray brace _____	Page: 14
• Attaching a tray _____	Page: 15
• Operating your PAW _____	Pages: 16
• Attaching the battery charger _____	Pages: 16
• Charging the batteries _____	Page: 17
• Operating your PAW _____	Page: 18
• Periodic Maintenance _____	Page: 18
• Troubleshooting _____	Page: 19
• Loose Wiring / 12 Volt Battery Removal _____	Page: 19
• Warranty and Product Registration _____	Page: 20



Congratulations and Thank You For purchasing your new PAW.

We have designed and built your new PAW with the goal of making your life easier. The PAW works great for many applications.

YOU NEED TO READ

**AND UNDERSTAND THE FOLLOWING CAUTIONS, SUGGESTIONS & WARNINGS TO
HELP YOU INSURE THE SAFE OPERATION OF YOUR PAW AND HOW TO ACHIEVE
THE GOOD HEALTH AND THE LONG LIFE OF, MOST IMPORTANTLY**

YOU

**AND SECONDLY
YOUR PAW**

YOU NEED TO ALWAYS KEEP IN MIND

Your PAW is a piece of power equipment and needs to be used with the care and caution required of all power equipment & tools. Never let an adult, child or pet ride in your PAW due to the risk of possible harm or injury.

Under no circumstances allow young children 16 years of age or younger to operate the PAW. Youth 16-18 years of age should **ONLY** be allowed to use the Paw with adult supervision. Failure to use caution while operating the PAW could cause injury to others and damage to property.

Always turn the power switch to the **OFF (0)** position when PAW is not in use.

Operate your PAW with the same care as what is required with any piece of power equipment.

Read through all the cautions and warnings below to insure a long, safe, and satisfactory relationship with your PAW.

**If you have any questions, please contact customer support at
1-800-495-9278 or at www.my-paw.com.**

ALWAYS KEEP IN MIND the PAW is a power tool. The PAW should be operated with care, especially when loaded. Avoid operating in the close proximity of adults, children, pets or objects. Keeping a safe distance is the best way to avoid possible harm or injury. Collisions with objects can result in damage to the object and/or your PAW.

Safety Guidelines

Carefully read, understand and follow all safety instructions in this manual.



This is the safety alert symbol. When you see this symbol, look for one of the following signal words.

DANGER

DANGER indicates a hazardous situation which, if not avoided, will result in death or serious injury.

WARNING

WARNING indicates a hazardous situation which, if not avoided, could result in death or serious injury.

CAUTION

CAUTION, used with the safety alert symbol, indicates a hazardous situation which, if not avoided, could result in minor or moderate injury.

NOTICE

NOTICE is used to address practices not related to personal injury.

Safety Information

Read these warnings carefully. Know the application and limitations of the PAW. Failure to follow these warnings could result in serious bodily injury and/or property damage.

DANGER

Never allow people, children or pets to ride in your PAW. Doing so can cause injury or harm to them.

DANGER

NEVER modify the electrical system. Alterations may cause serious injury and could ruin or permanently damage the components. Use of your PAW components in any other products or applications could cause overheating, fire or explosion resulting in harm, damage or injury to others or property.

DANGER

PAW should **NEVER** be immersed in water. Immersing the drive system or electrical components can cause operational failure of your PAW and possible electrical shock.

DANGER

NEVER use any components other than those supplied with Your PAW to charge the batteries. Use of other cables, chargers or any non-approved electrical equipment can cause electrical shock & fire resulting in possible harm and/or serious personal injury to you or others.

DANGER

ONLY USE AGM sealed type batteries. Non-sealed batteries can leak battery acid causing damage to property and harm to people or pets.

WARNING

NEVER allow children to charge the battery. Battery charging must be done by adults only. A child could be injured by the electricity involved in charging the battery.

WARNING

The battery must be handled by adults only. The battery is heavy and contains sulfuric acid (electrolyte). Dropping the battery could result in an acid leak and result in serious personal injury. If skin contact is made with battery acid – wash immediately with soap and water. If irritation continues seek medical attention.

WARNING

NEVER operate your PAW in an overloaded condition. Stacking material above the tray rim or over the sides of the tray can cause the PAW to be uncontrollably out of balance resulting in harm or injury to you or others, and damage to property.

WARNING

NEVER operate your PAW in an overweight condition. (200 pounds maximum load capacity) Weight capacity can also be limited by physical capability of the operator. Most healthy adults can operate the PAW safely with loads of up to 100 pounds. Operating with loads above 100 pounds is a personal decision and only you can judge your capability. Under no circumstances should you attempt to move a load weighing over 200 pounds.

WARNING

NEVER Touch the drive motor or axels after prolonged PAW use. It is normal for the drive components to get warm to the touch, even hot, after prolonged use. Failure to remember this can result in injury.

WARNING

NEVER operate your PAW or allow others to operate it while under the influence of drugs or alcohol.

WARNING

NEVER under any circumstance tow the PAW behind a vehicle.

CAUTION

NEVER use the PAW indoors, the PAW is designed for outdoor use only. Indoor use may cause damage to flooring or other household items.

CAUTION

NEVER operate your PAW without having both hands firmly grasping the handles. Failure to do this can cause loss of control, resulting in harm or injury to others and possible damage to property.

CAUTION

NEVER operate your PAW at speeds faster than a walk. (3 miles per hour) The tires are only designed for low speed use. Using your PAW at higher speeds may result in tire failure or blow outs and could cause injury to others and damage to property.

NOTICE

During snowy or rainy weather, the PAW should be stored inside or under a protective cover.

PAW BATTERIES

It is recommended to **fully charge your batteries** installed in your PAW before each use. Always charge the batteries in the upright position. For best results, charge the batteries while installed in your PAW. When in storage keep the battery box and/or PAW in an upright position with the PAW drive wheels and both support legs flat on level ground.

Cold weather storage: For prolonged storage in below freezing temperatures it is recommended to unplug and remove the PAW battery box from the PAW chassis. During long winter storage it is recommended to periodically recharge the batteries using the PAW charger to insure longer life.

Your PAW comes with 2 - 12 volt high quality, **safety sealed**, AGM type batteries. Like all batteries they contain battery acid. Your PAW batteries meet the AGM safety standard. This means they have extra protection to insure they stay sealed. However, if they are dropped or misused they may crack or break allowing for an acid leak. Inspect your batteries regularly to insure there is no sign of acid leak.

⚠ DANGER **NEVER** charge the Paw in a wet or moist environment. Never charge your PAW while PAW is in contact with water.

⚠ WARNING If acid comes in contact with skin or eyes, flush immediately with water for at least 15 minutes and if irritation persists call a physician.

⚠ WARNING If acid is internally ingested, give water, milk of magnesia or egg whites immediately. Never give emetics or induce vomiting. Seek professional medical help immediately.

⚠ WARNING If a battery leak develops, avoid contact with the leaking acid and place the damaged battery in a plastic bag. See "Battery Disposal" for proper disposal.

⚠ CAUTION Before charging the battery, examine the battery case for cracks and other damage which may cause sulfuric acid (electrolyte) to leak during the charging process. If damage is detected, do not charge the battery or use it in your PAW. Battery acid is very corrosive and can cause severe damage to surfaces it contacts. Using acid resistant gloves – put the leaking battery in a heavy plastic bag and dispose in accordance with local regulations. It is unlawful to dispose of your batteries in normal municipal trash services. Batteries must be taken to an authorized battery return operations. Most retail outlets that sell batteries are required to take all batteries for disposal. Or check with your local municipality for the disposal location nearest you for instructions on proper disposal.

NOTICE Battery must be upright while charging. If power flow to the wall outlet is controlled by a switch, make sure the switch is on. Use the PAW charger only in a wall outlet. Never plug the charger into a ceiling outlet.

NOTICE Do not place the battery on a surface (such as kitchen counter tops) which could be damaged by the acid contained inside the battery. Take precautions to protect the surface on which you place your battery.

Battery Disposal:

NOTICE Your battery is a non-spillable, sealed lead-acid battery. It must be recycled or disposed of in an environmentally sound manner. Do not dispose of a lead-acid battery in a fire as the battery may explode or leak. Do not dispose of a lead-acid battery in your regular household trash. The incineration, landfilling or mixing of sealed lead-acid batteries with household trash is prohibited by law in most areas. Return an exhausted battery to a federal or state approved lead-acid battery recycler, such as a PAW authorized dealer or seller of automotive batteries. Contact your local waste management officials for other information regarding the environmentally sound collection, recycling and disposal of lead-acid batteries. If you live in the State of Florida or the State of Minnesota, it is prohibited by law for anyone to throw away lead-acid batteries in the municipal waste stream.

PROPER TIRE CARE

⚠ WARNING Improper tire pressure may cause unstable PAW operation and can result in a tire blowout and/or loss of control. Therefore, before each use check the tire pressure. Improperly inflated tires cause tires to wear out prematurely and may result in loss of control resulting in harm or injury to yourself and others.

Your PAW tires are only designed for low speed use. Optimum and maximum operating air pressure is 30 pounds per square inch (PSI). Your PAW tires come pre-inflated from the factory. It is a good idea to check the initial pressure to insure the proper 30 PSI pressure required. It is recommended to check the tire pressure before each use. Do not over inflate you PAW tires. Over inflation can result in tire/rim failure and/or possible tire explosion that may cause harm and injury to you, others and damage to property.

Your PAW tires have treads to help it maintain traction and stability. It is essential to inspect the tires before each use. If a tire is cracked, has a bald spot, bulge, cuts, any cords showing, or has uneven tread wear, replace the tire with a PAW approved tire before further use. Tires with damage or with too little tread will not provide adequate traction which could result in loss of control, possibly leading to serious injury.

Parts Inventory

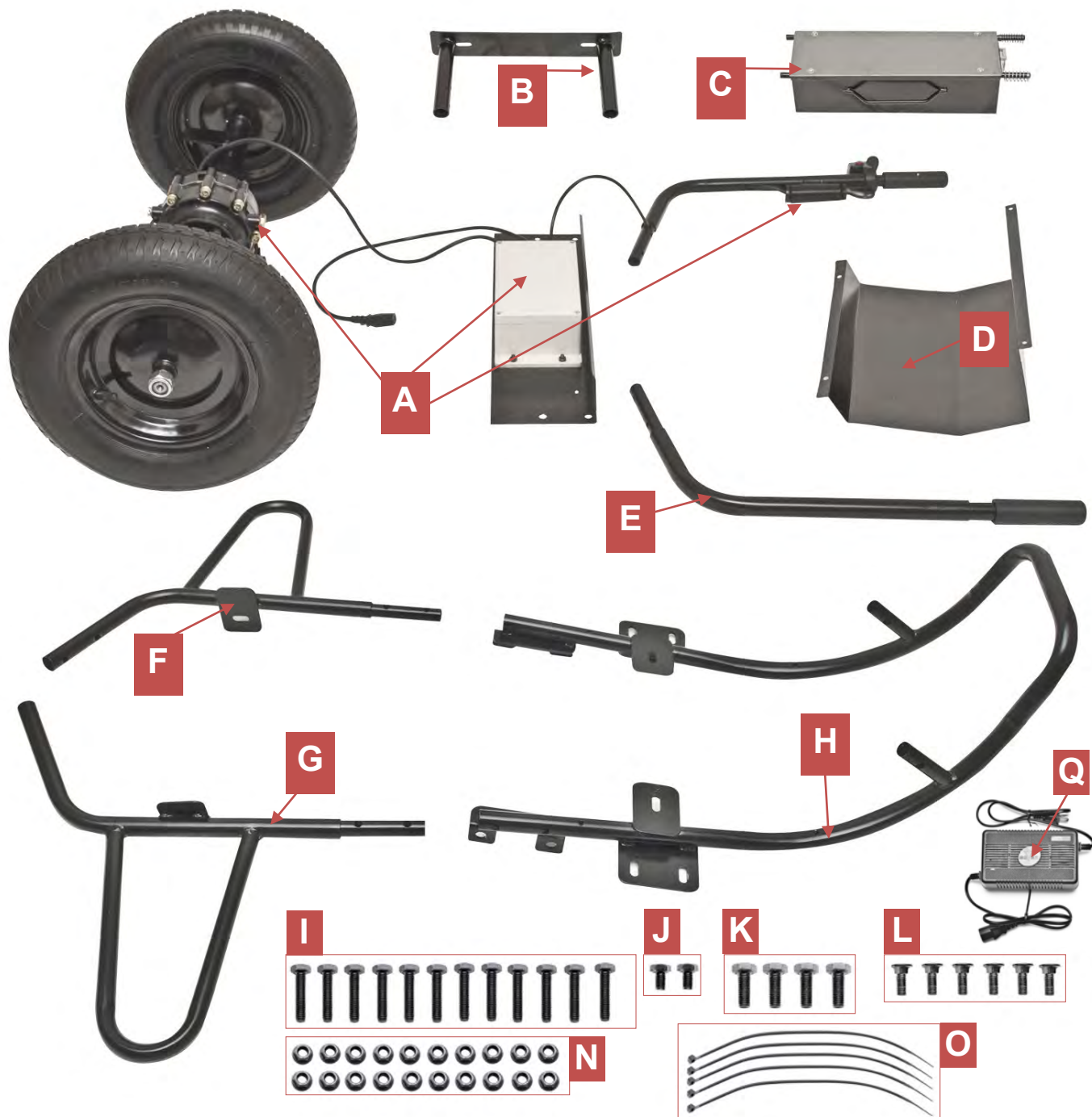

- A. Drive system and electronics
- B. Tray brace
- C. Battery box
- D. Motor protective cover
- E. Left handle
- F. Left support leg
- G. Right support leg
- H. Dump support brace
- I. M8 x 35mm hex bolt (QTY: 12)

- I. M8 x 35mm hex bolt (QTY: 12)
- J. M8 x 12mm hex bolt (QTY: 2)
- K. M10 x 15mm hex bolt (QTY: 4)
- L. M8 x 20mm carriage bolt (QTY: 6)
- N. M8 hex nut (QTY: 20)
- O. Zip tie (QTY: 5)
- P. Owner's Manual
- Q. Battery charger



P

Assembling the main frame

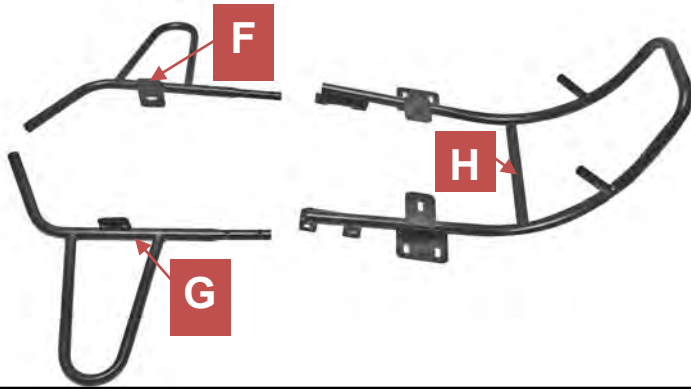

1. Lay out the left support leg (F), right support leg (G), and dump support brace (H) as shown.



2. Insert the right support leg (G) into the dump support brace (H) as shown above.

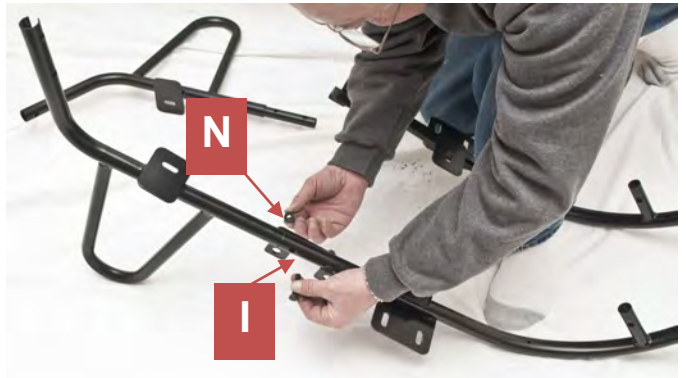

3. Using (QTY 2) M8 x 35mm hex bolts (I) and (QTY 2) M8 hex nuts (N) secure the right support leg (G) to the dump support brace (H).

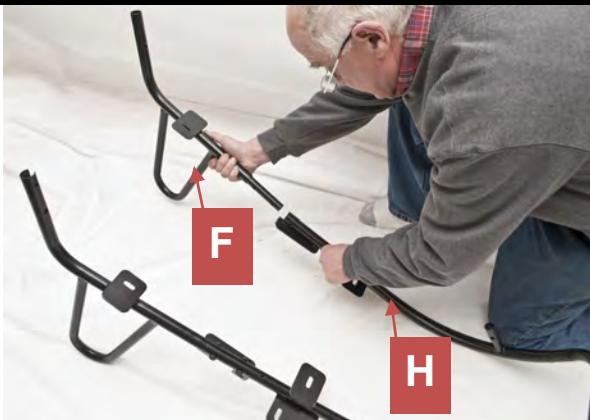

4. Insert the left support leg (F) into the dump support brace (H) as shown above.

Assembling the main frame and drive system



5. Using (QTY 2) M8 x 35mm hex bolts (I) and (QTY 2) M8 hex nuts (N) secure the left support leg (F) to the dump support brace (H). Align the legs and tighten fasteners securely.

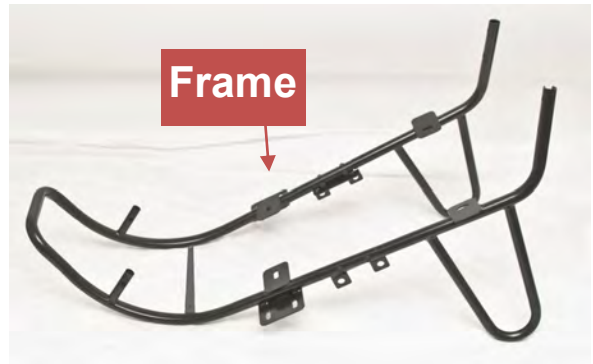
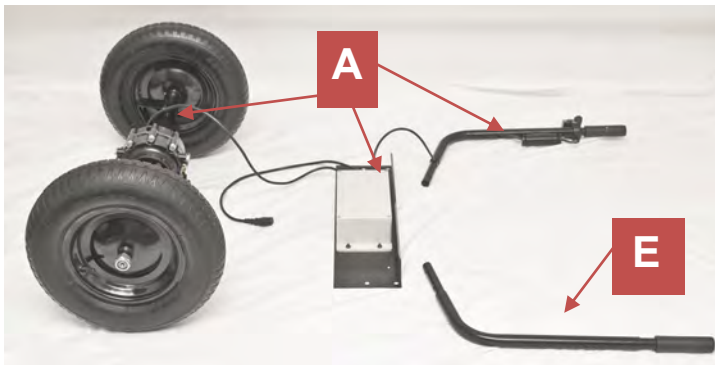

6. Lay out the drive system and electronics (A), left handle (E), and completed frame as shown above

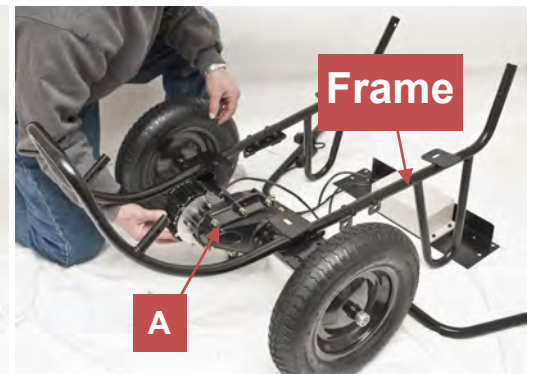
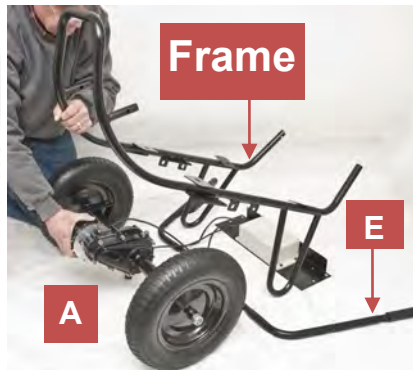
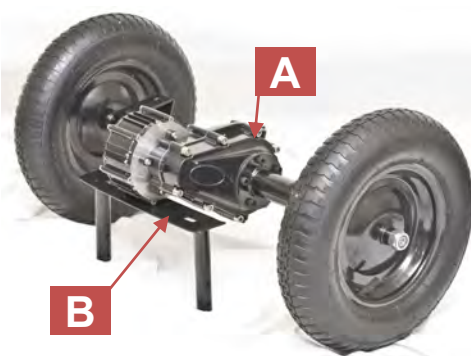

7. While grasping the drive system motor (optional: use tray brace (B) to support motor) pull the assembled frame over the drive system aligning with the mounting holes. See below.

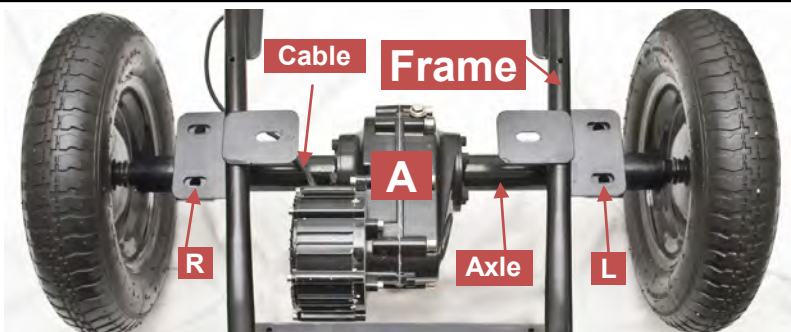

8. Align the frame mounting holes (R & L) with the mounting holes on the drive system axle (R & L). It is very important that the frame and drive system line up properly.
9. The drive system motor electronics cable should go over the top of the drive axle. See image to the left for proper placement.

Assembling the drive system and left handle

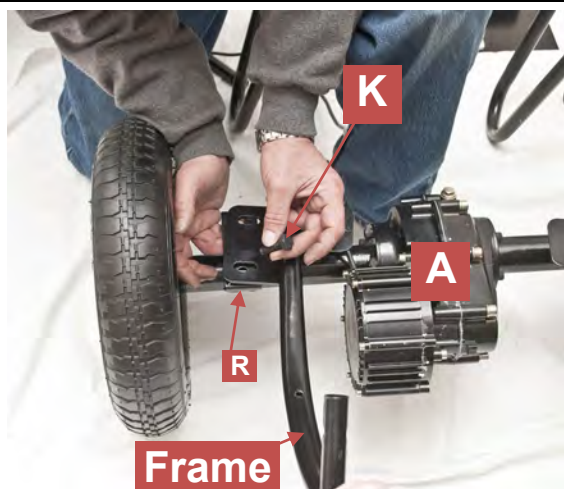

10. Using (QTY 2) M10 x 15mm hex bolts (K) secure the right side frame support (R) to the frame.

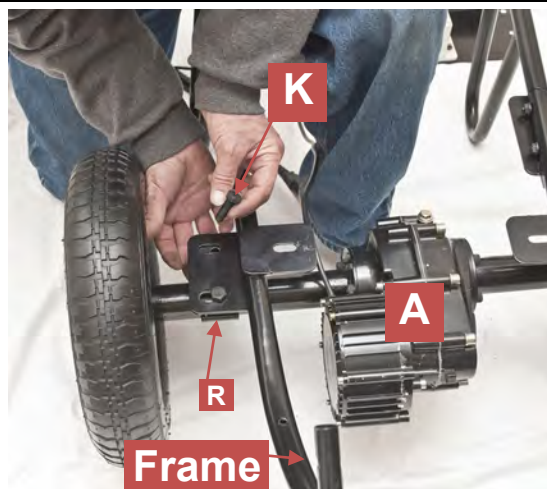

11. Using (QTY 2) M10 x 15mm hex bolts (K) secure the left side frame support (L) to the frame.

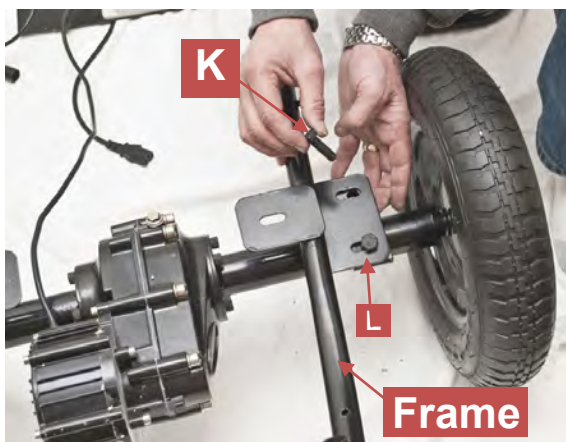

12. Once assembled the frame and drive system assembly should look like the photo at the left.



13. Insert the left handle (E) into the assembled frame as shown in the above photo.

Attaching the electronics box and right handle

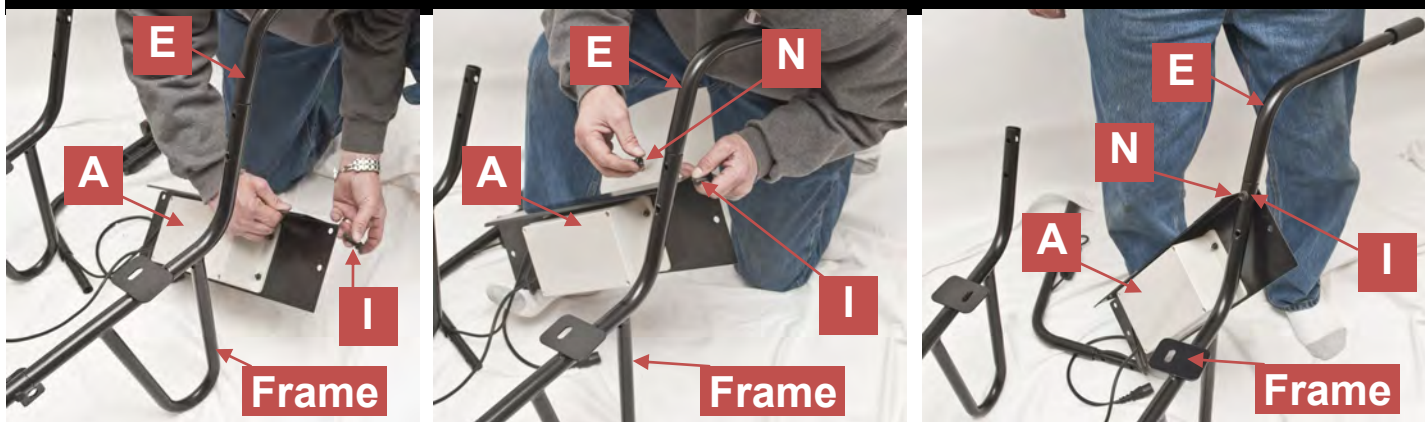

14. Using (QTY 1) M8 x 35mm hex bolts (I) and (QTY 1) M8 hex nuts (N) attach the electronic box (A) to the frame and left handle (E).

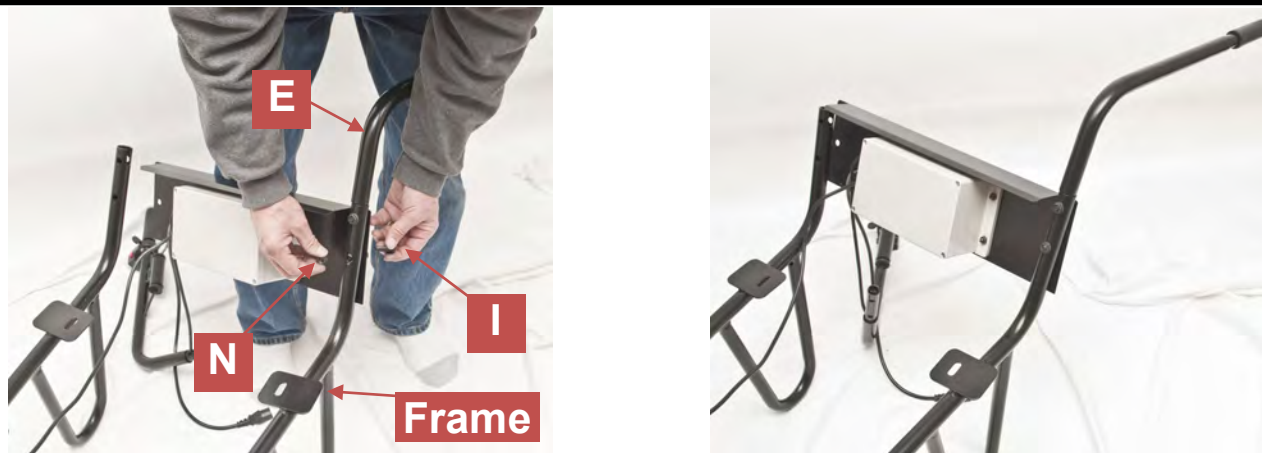

15. Using (QTY 1) M8 x 35mm hex bolts (I) and (QTY 1) M8 hex nuts (N) attach the electronic box (A) to the frame and left handle (E).

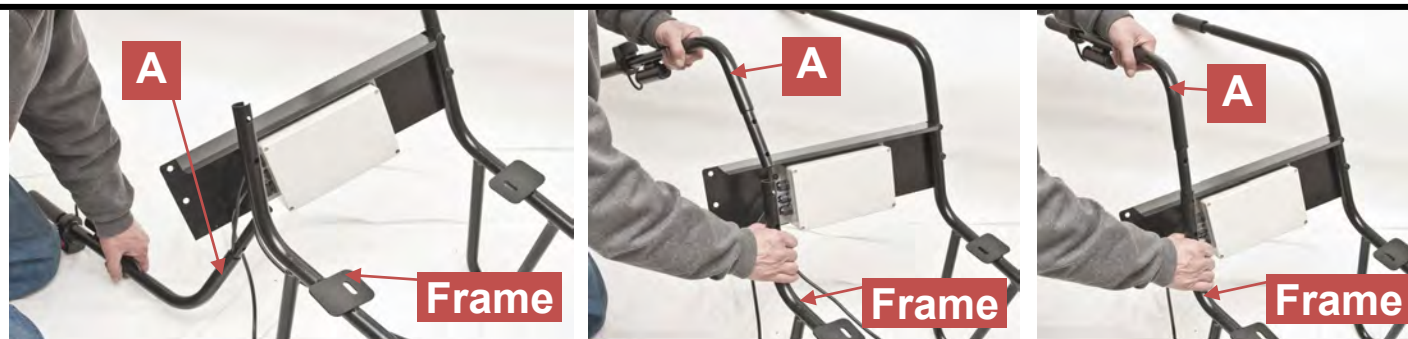

16. Insert the drive system right handle (A) with throttle into the frame as show in the images above.

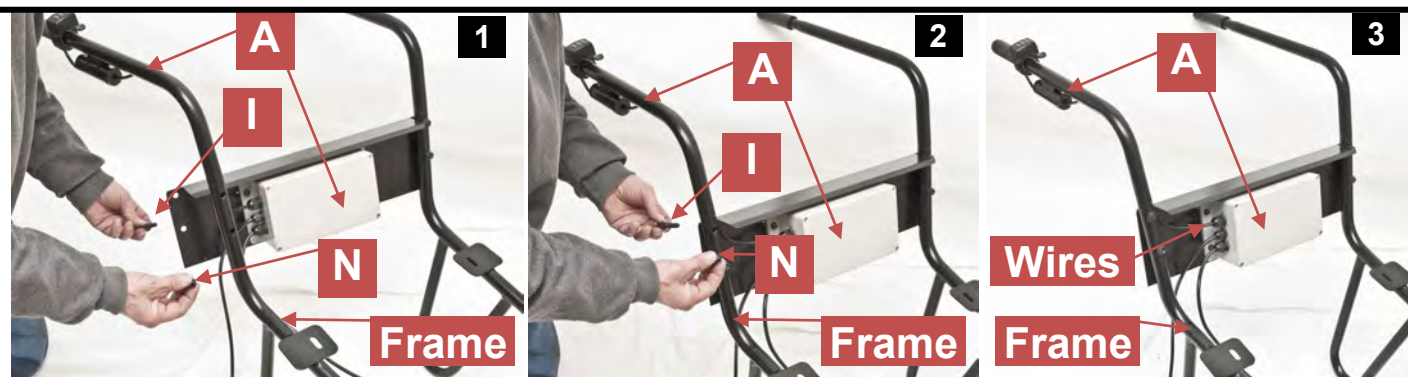

17. Using (QTY 2) M8 x 35mm hex bolts (I) and (QTY 2) M8 hex nuts (N) attach the electronic box (A) to the frame and right handle with throttle (E). All three wires should be laid out as shown in the third photo.

Attaching the motor protective cover

18. IMPORTANT! Tighten all frame bolts using wrenches. Take special care to make sure all frame parts are aligned.



19. Insert the motor protective cover (D) under the assembled frame and drive system as shown in the above images. Take care not to damage the drive system when attaching the motor protective cover (D).

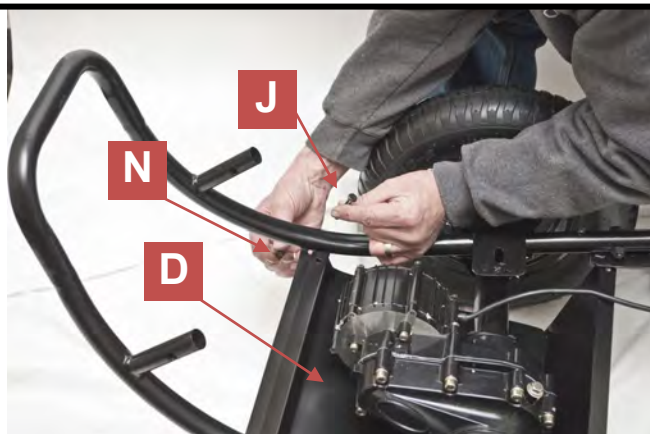

20. Using (QTY 2) M8 x 12mm hex bolts (J) and (QTY 2) M8 hex nuts (N) attach the front of the motor protective cover (D) to the frame.



20. Using (QTY 2) M8 x 35mm hex bolts (I) and (QTY 2) M8 hex nuts (N) attach the rear of the motor protective cover (D) to the frame.

21. Tighten all four motor protective cover bolts and nuts using two wrenches.

Attaching the battery box

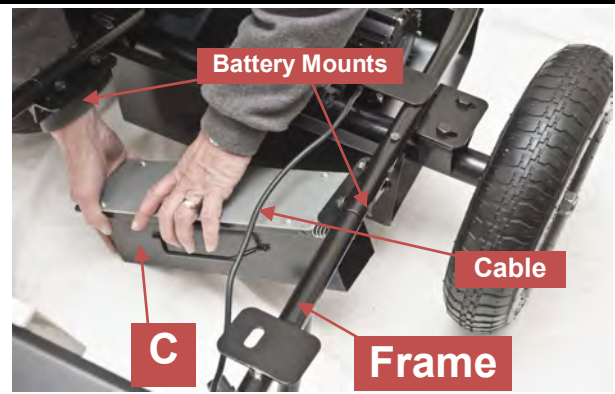
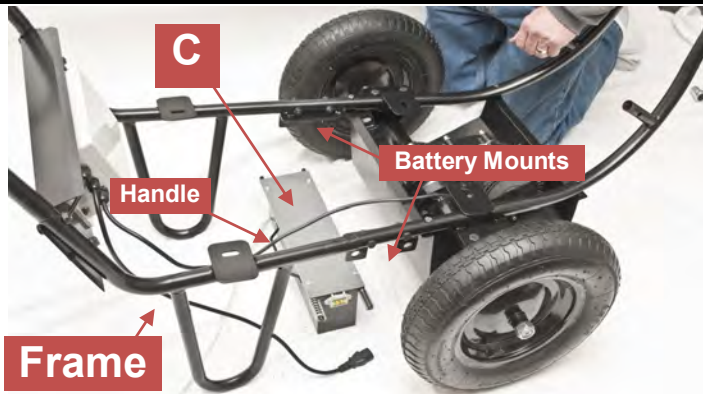

22. Positioning the handle side of the battery box to the rear - Insert the right side (spring side) of the battery box (C) into the right battery mount holes located in the frame. The drive system electronics cable should go over the top of the battery box (C) as shown.

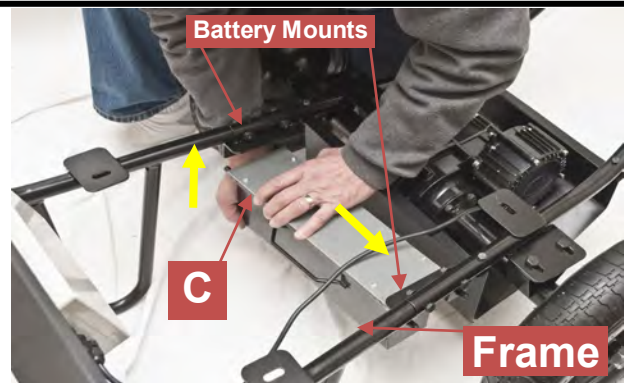
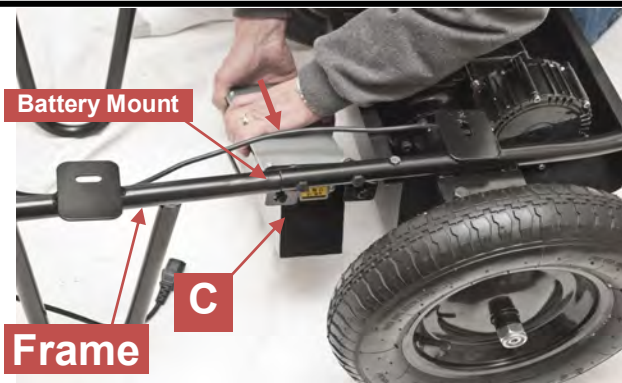

23. Push the battery box (C) to the right side battery mount to compress the battery box (C) springs.

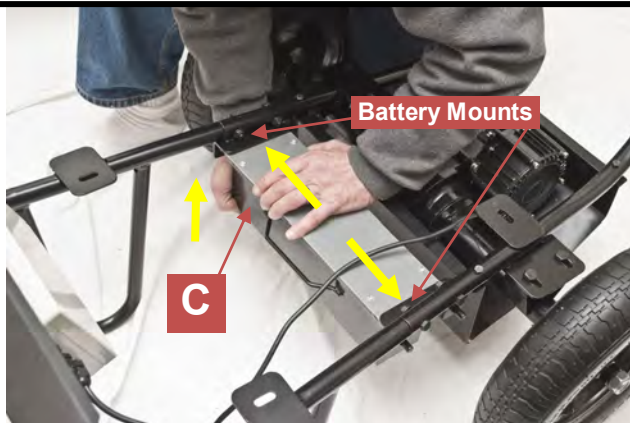

24. Lift battery box (C) up and insert into the left side battery mounts. Push battery box (C) to left to secure.



25. Insert the power plug into the power outlet on the right side of the battery box (C). Push in to secure.

Attaching and adjusting wiring

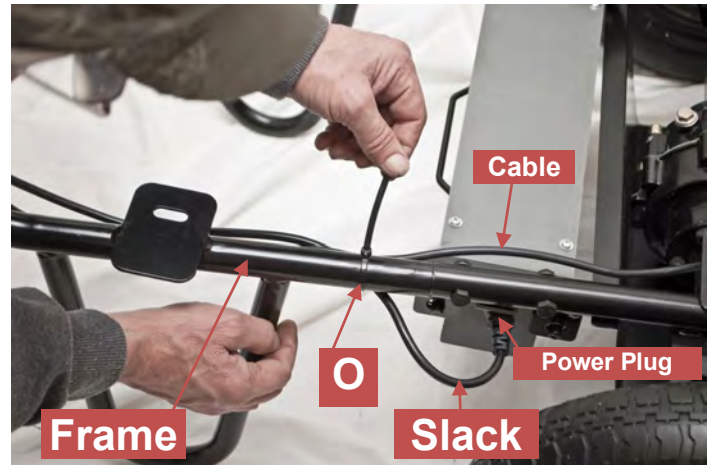
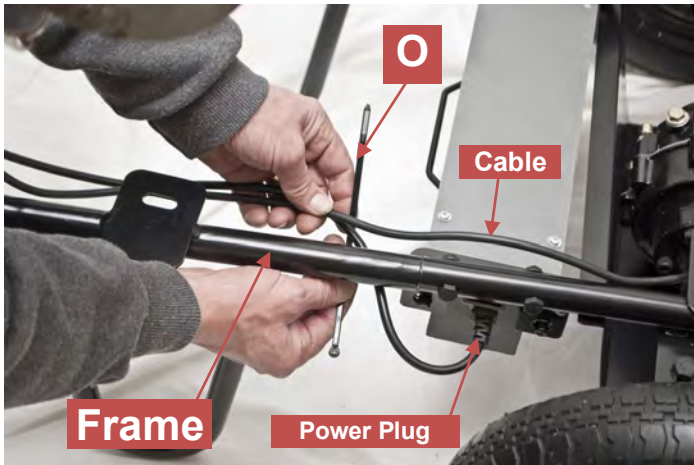

26. Using a zip tie (O) secure the power plug wire and drive system electronics cable to the frame. Be sure to leave enough **slack** so the power plug can be pulled easily from the battery box for recharging.

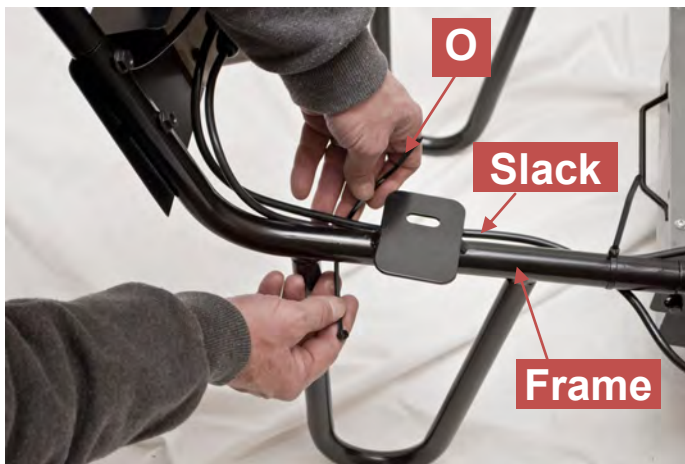

27. Using a zip tie (O) secure the power plug wire and drive system electronics cable to the frame as shown in the above photos. Make sure to leave **slack** between the two zip ties (O). This slack will be necessary for mounting the tray to the frame.

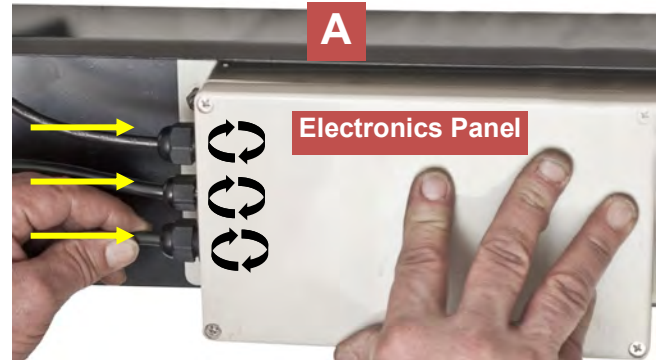
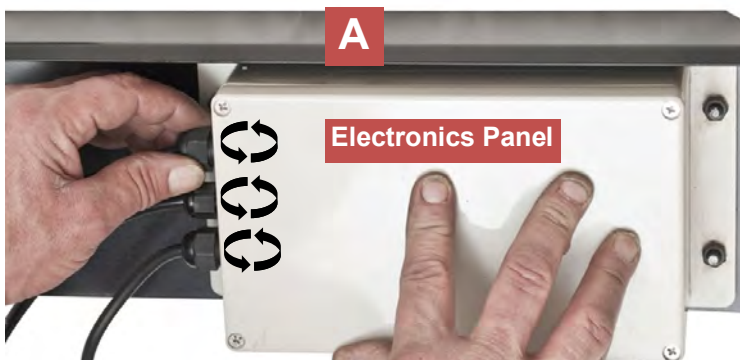

28. Loosen all three black nuts on the electronic panel by turning nuts counter clockwise.

29. Push any extra slack of all three wires into the electronics panel.

30. Tighten all three black nuts on the electronics panel by turning nuts clockwise.

Attaching the tray brace

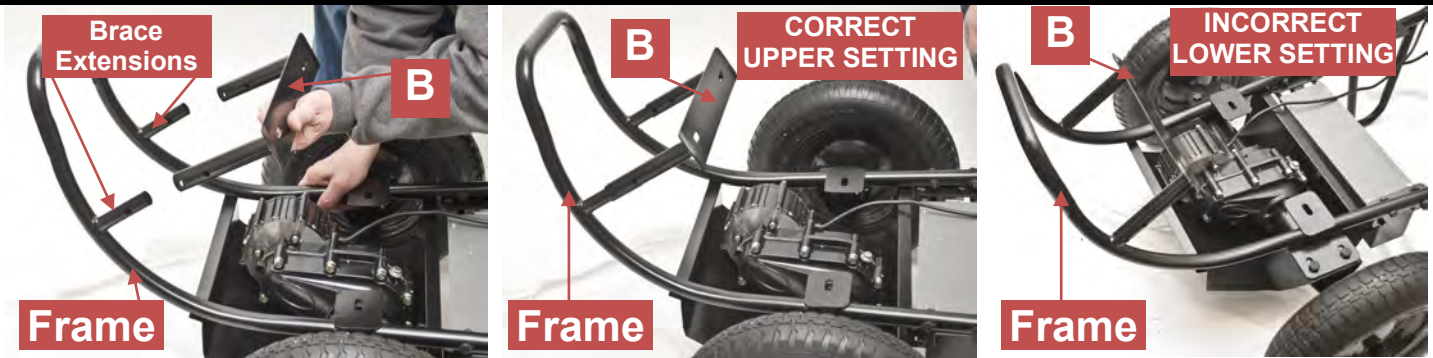

31. Slide the tray brace (B) onto the frame brace extensions. Note: there are two separate heights the tray brace (B) can be set. The upper setting is the correct position.

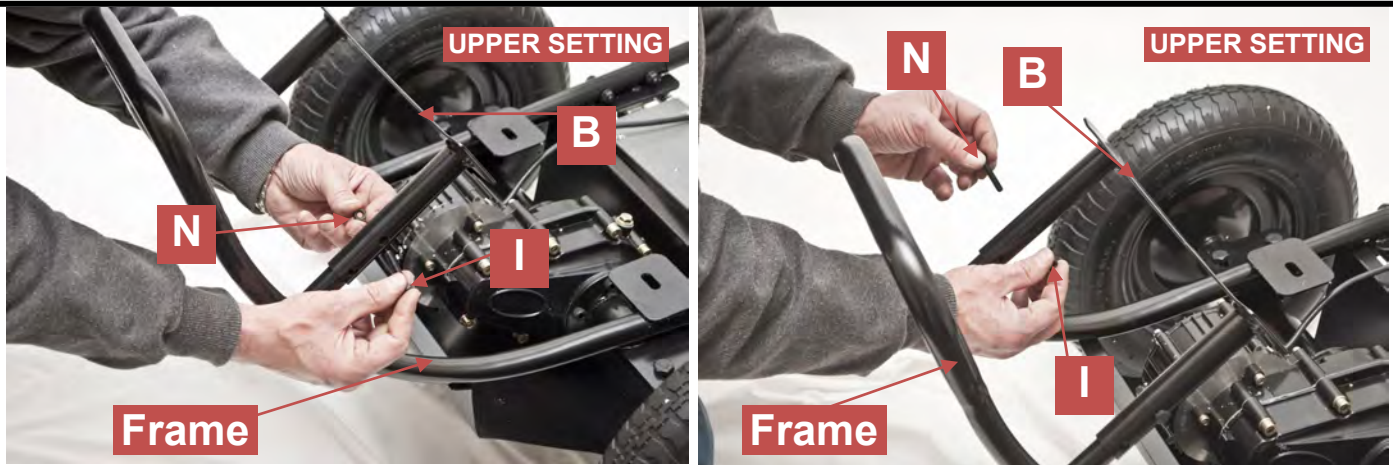

32. Mount the tray brace (B) in the upper setting. Using (QTY 2) M8 x 35mm hex bolts (I) and (QTY 2) M8 hex nuts (N) attach the tray brace (b) to the frame.



34. The PAW is now assembled and ready for operation.

35. You will next need to attach a tray (sold separately). It is not recommended to load and use the PAW without a tray as this may cause damage to the PAW.

Attaching a tray (sold separately)

**Purchase a 6 Cu. Ft. tray, sold separately*

36. Lower the tray* onto the PAW frame. Line up all holes in the tray with the holes in the PAW frame brackets.



Suggestion: It will be easier to insert all 6 mounting bolts if you do not tighten them until they are all in place.

37. Install (QTY 2) M8 x 20mm carriage bolts (L-Top) into the front/top two holes of the tray. These two bolts (L-Top) go through the tray brace (B).
38. Install (QTY 4) M8 x 20mm carriage bolts (L) into the bottom four holes of the tray. These four bolts (L) go through the frame brackets.

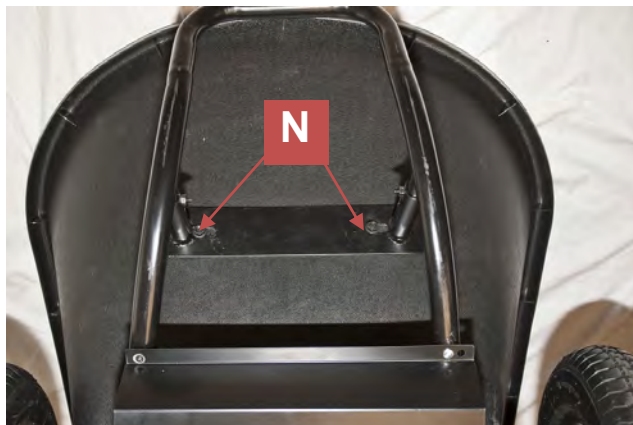

38. Install (QTY 2) M8 hex nuts (N) onto the front/top (QTY 2) M8 x 20mm carriage bolts (L-Top).

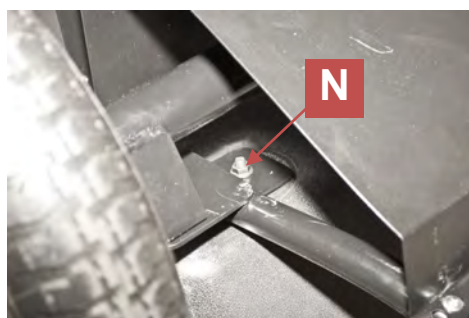

39. Install (QTY 4) M8 hex nuts (N) onto the bottom four (QTY 4) M8 x 20mm carriage bolts (L).
40. Tighten all (QTY 6) M8 hex nuts (N) using a wrench.

Operating your PAW

⚠ CAUTION 41. **Watch for Hazards:** Using the PAW on or near steep inclines can cause your PAW to be uncontrollable and cause injury to yourself & others and or damage to property. On steep inclines/declines, the PAW could reach an unsafe speed. Operating the PAW on steep inclines/declines can cause the PAW to tilt, tip, or possibly roll over. Another danger is loss of drive wheel traction. All of the above can cause the PAW run out of control resulting in possible harm and injury to yourself and/or others. It can also result in damage to your PAW and/or other property. At all times keep your feet firmly on the ground and two hands on the PAW handles to maintain control.

42. **BEFORE OPERATION OF YOUR PAW:** Your new PAW is similar to any other power driven tool. Although very easy to operate it will take some familiarity with the controls and balance to master it fully. Before operating the PAW, it is a good idea to get familiar with controlling your PAW. Your PAW operates in much of the same way as a standard manually operated wheel barrow, the only major difference is your PAW has an optional forward/reverse power assist. According to your physical capability, the PAW can easily be moved directionally as you desire.

43. **MANUAL OPERATION OF YOUR PAW:** With power switch in the **OFF (0)** position take the PAW to a large open outside area. Grasp the PAW handles with both hands, lift the PAW until the support legs are off the ground and the weight of the load is transferred to the drive wheels. In this position manually push forward, backwards, and practice turning the PAW. To dump the PAW, lift both handles in an upward forward motion pivoting on the drive wheels and onto the dump support brace until the tub is in a vertical position.

Power Switch

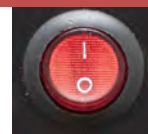

Attaching the battery charger



44. Lay out the battery charger (Q) as shown. Battery charger (Q) vents must face upwards.

45. Remove the power plug from the power outlet located on the right side of the battery box (C).

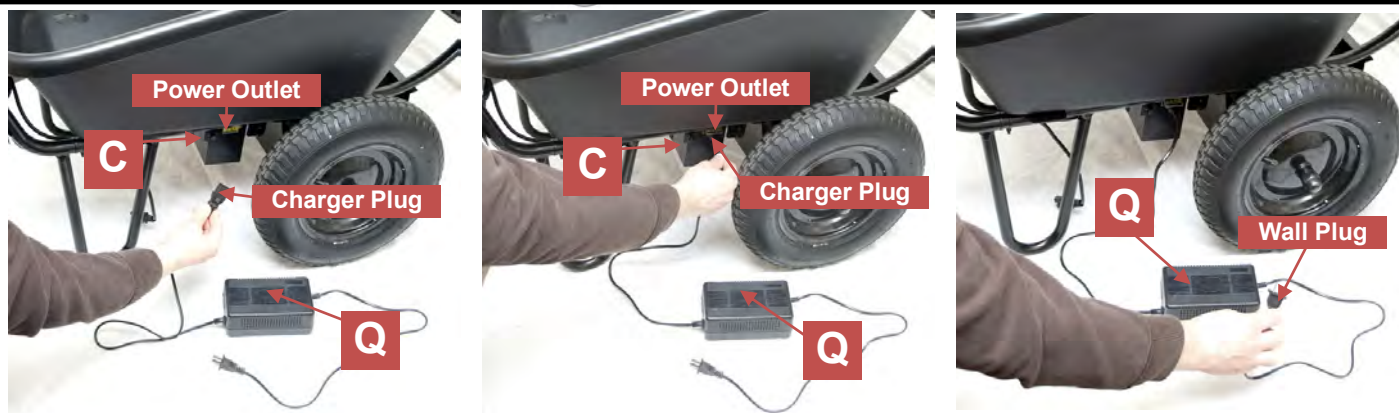

46. Install the charger plug from the battery charger (Q) into the power outlet on the battery box (C).

47. Plug the wall plug from the battery charger (Q) into a wall outlet, a GFCI outlet is recommended.



Only charge your PAW batteries in an open, dry, well-ventilated area. **ONLY** use the charger supplied with your PAW. Use of other charging systems could damage the unit and may cause harm to you.



If your indicator light does not change to green within 24 hours, call us at 1-800-495-9278 or visit us online at my-paw.com. The charger has a built in safety switch that prevents overcharging of the batteries.



To purchase replacement batteries or charger contact customer service at 1-800-495-9278

Charging the batteries

48. Your Paw comes with partially charged batteries, (normally 60 to 70%) And it should operate normally once assembled. However, it is a good idea (although not necessary) to bring your batteries up to a full charge before operating. See page 5 for battery information.
49. Connect the battery charger as shown on page 17. When the indicator light turns from red to green on the charger the PAW is ready for operation. The amount of time needed full charge the batteries will vary from ½ hour to up to 12 hours.
50. Once battery is charged unplug the charger and reinstall the power plug by reversing all previous steps in the “attaching the battery charger” section on page 17.
51. Once you have become comfortable maneuvering the PAW with power OFF and the batteries are fully charged, it is time to turn the power ON.

Operating your PAW

52. **POWER ASSIST OPERATION OF YOUR PAW** Use the same care when operating the PAW in both manual and/ or power assist modes.
53. Turn **ON (I)** the power switch located on the electronics box. The battery indicator lights should illuminate on the top of the control module mounted on the right handle. (If they do not illuminate see the troubleshooting section) Your PAW is now ready for operation.

Power Switch



Indicator Lights



No lights = No charge available because power switch off or power plug is not installed.

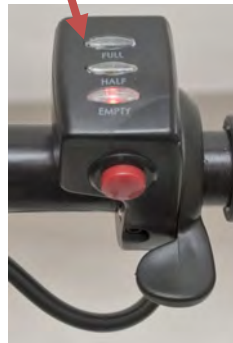

Empty light = Battery at lowest charge and should be recharged soon for best operation.

Indicator Lights



Full light = Full charge battery is at full charge and ready for operation.

PAW Controls

Indicator Lights



Forward/Reverse

Throttle

Forward Reverse Button:

The red forward and reverse button is located on the right handle control module. Pushing this red button will change the direction of forward or reverse.

Reverse:

In the reverse position the PAW is designed to achieve a walk speed. This low walking speed is designed for safety reasons. Take **CAUTION** when the PAW is in reverse with both hands on the handles and solid footing.

Forward:

The forward position has a built in additional power boost when throttle is pushed down fully. At full throttle the PAW will move forward at a very fast walk speed. Take special care when using full throttle. The use of power boost is designed for use when climbing hills with the tray loaded.

Operating your Paw

54. **Operation:** With the power button in the **ON** position, a direction selected (forward or reverse), both hands on the handles and solid footing **SLOWLY** press the thumb throttle located on the right handle. This is the variable speed/power control. The further the thumb throttle is pressed down, the more speed/power your PAW will develop. It is recommended to start at slower speeds of operation until you feel comfortable with your PAW.



55. **POWER OPERATION OF YOUR PAW** With power switch in the **ON** position take the PAW to a large open outside area. Grasp the PAW handles with both hands, lift the PAW until the support legs are off the ground and the weight of the load is transferred to the drive wheels. In this position power forward, backwards, and practice turning the PAW. To dump the PAW, release the throttle, lift both handles in an upward forward motion pivoting on the drive wheels and onto the dump support brace until the tub is in a vertical position.



56. **Normal Stopping your PAW:** To stop your PAW fully **release** the thumb throttle and slowly bring the PAW to a stop. Once at a stop lower the PAW onto the support legs.
57. **FORCED STOPPING OF YOUR PAW:** In some situations the support legs can be used for additional slowing. While in motion **release** the thumb throttle and by using both handles slowly lower the PAW onto the support legs to slow the PAW to a stop. If necessary downward force can be applied to both handles for additional braking. Take care when using the support legs for stopping as too much pressure may damage your PAW or cause the PAW to become unstable. During emergency stopping, the support legs may cause damage to the stopping surface.
58. **Operating temperature ranges:** The PAW has an operational range from 110 degrees to minus 10 degrees Fahrenheit. It needs to be noted that the PAW will be affected by colder temperatures. Cold temperatures cause the PAW to become sluggish, before operating at full capacity and at speed make sure your PAW's drive system has warmed up. For optimum performance at Temperatures below 32 degrees it is recommended to keep the load below 100 lbs.

Periodic Maintenance

Charger: Regularly examine the charger for damage to the cord, plug, housing or other parts that may result in the risk of fire, electric shock or injury. In the event of any damage, do not use the charger until the damage has been properly repaired.

Tires: Check to make sure the lug nuts on the tires are secure. Loose lug nuts may cause the tire to come loose and result in the loss of control. Tires are recommended to be filled to 30 psi.

Hardware: Periodically check all fasteners/hardware for proper tightness. Retighten any loose hardware.

Motor Oil: Periodically check the oil level in the drive system. To check oil level remove the fill bolt and check to see there is oil in the drive system. If necessary add additional 5w30 engine oil to the drive system.

Wire Connections: Periodically check all wire connections.

Troubleshooting

Problem	Possible Cause	Solution
PAW does not run. PAW was running but suddenly stopped. Short run time (less than 1-3 hours per charge). PAW runs sluggishly. Battery lights do not illuminate.	Undercharged battery .	Charge the battery. A new battery should have been charged for at least 12 hours before using the PAW for the first time. After first-time use, recharge the battery until the green charge light illuminates.
		Check all connectors. Make sure the charger connector is plugged into the battery box, and that the charger is plugged into the wall.
		Make sure power flow to the wall outlet is "ON".
	Charger is not working.	There is no sure way to tell if your charger is working unless you have a volt meter. If you suspect there is a problem with your charger, contact customer service.
	Loose wire or loose connectors.	Check all wires and connectors. Make sure the motor harness connector is plugged into the battery, and that there are no loose wires .
	Dead battery.	Charge the battery as shown on page 17 of the Owner's manual.
	Motor damage.	Contact customer service for diagnosis and/or repair.
	Overcharged battery.	Do not charge the battery longer than 30 hours. If you suspect damage due to overcharging, contact customer service.
	PAW is overloaded and/or running conditions are too stressful.	Make sure not to overload the PAW, maximum capacity is 200lbs or run in a less stressful environment.
Sometimes the PAW doesn't run but other times it does.	Loose wire or connector.	Check all wire connections to make sure they are tight.
	Motor or electrical damage.	Contact customer service for diagnosis and repair.
Battery makes a sizzling or gurgling noise when charging.	It is normal for the batteries to make noise or swell slightly while charging and is not reason for concern.	No Action Required.
		If your battery does not make noise or swell slightly during charging, it does not mean that it is not accepting the charge.
One or more tires are flat.	Tire has lost air.	Inflate the tire with air to 30 psi.
	Tire puncture.	Patch or replace damaged inner tube.
	Leaky tire air valve.	Replace or tighten tire air valve.
Paw feels loose or less solid then initial assembly.	PAW hardware has become loose.	Retighten all hardware using tools.

Loose Wiring / 12 Volt Battery Removal

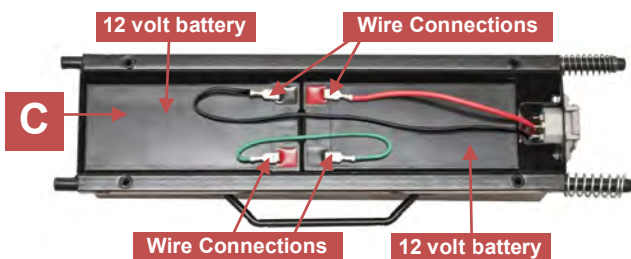

Remove: the battery box (C) from the PAW. Remove all four screws securing the battery box (C) lid and remove lid.

Battery Box (C) Wiring: Loose wiring inside the battery box can cause the PAW not to operate. Take care to check that all wire connections are secure.

Battery Removal: To remove the two 12v batteries remove the black, red and green wire connections. Pull each of the batteries up and out of the battery box (C).

LIMITED WARRANTY AND LIMITATION OF LIABILITY

Decko Products warrants this product, to the original purchaser, for the initial residence in which it is located (upon verification that it is assembled correctly) to be free from defects in materials and or workmanship for a period of 1 YEAR from the date of purchase, with the exception that certain components which wear out upon normal use are excluded from this warranty. Examples of such components include but are not limited to; tires, rims and transmission. As the sole and exclusive remedy for a breach of this limited warranty, if the product is found to be defective by Decko Products, Decko Products, at its option, will repair the product or replace it with an equivalent product. If this product should fail during the limited warranty period call 1-800-495-9278 toll free to file a Warranty claim. If the product is deemed by Decko Products to contain a manufacturer's defect covered by this limited warranty and if it is determined it cannot be fixed at the original location.

Send product post paid to:

**Decko Products,
ATTN: Warranty Dept.,
2301 Traffic Street NE
Minneapolis, MN 55413**

Please include a brief description of the problem and a dated proof-of-purchase receipt with any product returned for warranty repair. Defective product will be repaired or replaced with new or factory-rebuilt parts at manufacturer's sole option. Any costs unrelated to a manufacturer's defect are not covered by this Limited Warranty. As the owner of the product, you are solely responsible for any such unrelated costs which may be incurred. In order to ACTIVATE YOUR WARRANTY, the original purchaser must register the product using the form below or online at www.my-paw.com within 30 days of purchase. A copy of the original receipt must accompany the warranty registration.

- **ANY ABUSE, MODIFICATION OR DISSASSEMBLY OF THIS PRODUCT VOIDS THIS LIMITED WARRANTY.**
- **DECKO DISCLAIMS ALL OTHER EXPRESS OR IMPLIED WARRANTIES INCLUDING WARRANTIES OF MERCHANTABILITY OR FITNESS FOR A PARTICULAR PURPOSE.**
- **DECKO PRODUCTS SHALL NOT BE LIABLE FOR CONSEQUENTIAL OR INCIDENTAL DAMAGES THAT ARISE IN CONNECTION WITH USE, OR INABILITY TO USE THIS PRODUCT.**

This warranty shall not apply to damage due to acts of God, normal wear and tear, normal maintenance services and the parts used in connection with such service, lightning, or have been subject to negligence, abuse, accident, misapplication, tampering, alteration; nor due to improper installation, operation, maintenance, or storage; nor to excess of recommended maximums as set forth in the instructions, or conditions beyond the control of Decko Products.

Any oral statements about the product made by the seller, Decko Products, the representatives, or any other parties do not constitute warranties, shall not be relied upon by the user, and are not part of the contract for sale. Sellers' and Decko Products' only obligation and the buyer's only remedy, shall be the replacement and/or repair by Decko Products of the product as described above. Neither seller nor Decko Products shall be liable for any injury, loss or damage, direct or indirect damages, incidental or consequential damages, (including but not limited to incidental or consequential damages for lost profits, lost sales, injury to person or property,) or any other incidental or consequential loss arising out of or related to the use or the inability to use the product, and the user agrees that no other remedy shall be available to it. Before using the product the user shall determine the suitability of the product for his/her intended use and user assumes all risk and liability whatsoever in connection therewith.

The warranty and remedy in this limited warranty is an exclusive warranty and remedy and is in lieu of any other warranty or remedy, expressed or implied, which other warranties and remedies are hereby expressly excluded, including but not limited to any implied warranty of merchantability or fitness for a particular purpose. To the extent either applies to a product it shall be limited in duration to the periods of the expressed limited warranties given above. Some states do not allow the exclusion or limitation of consequential or incidental damages, so the above limitation or exclusion may not apply to you. This limited warranty gives you specific legal rights, and you may also have other rights which vary from state to state.

**To activate warranty - register online at www.my-paw.com
or fill out and mail in completed form below**

REGISTRATION CARD

Customer First Name: _____

Customer Last Name: _____

Customer Address: _____

City: _____ State: _____

Zip Code: _____

Phone Number: _____

Email Address: _____

Model Number: _____

Place of Purchase: _____

Date of Purchase: _____

Commercial Application: Yes No

Did purchaser assemble the product: Yes No

If no, who assemble the product?: _____

Cut along dotted line and mail card to:

**Decko Products,
ATTN: Warranty Dept.,
2301 Traffic Street NE
Minneapolis, MN 55413**

OR REGISTER AT WWW.MY-PAW.COM